

SWIFT TRAWLER



NEW SWIFT TRAWLER 47 THE BEST WAY TO TRAVEL

GIVRAND, FRANCE, JULY 2018



The new Swift Trawler 47 is as distinctive as ever and she is the ideal boat for boating with family and friends. With greater room, cruising range and power, the latest member of this legendary Beneteau range proudly boasts its ambition to take you further faster, while offering unique freedom and an incredible feeling of space. Elegant and affordable, the Swift Trawler 47 will make a debut on the international boating scene at the upcoming Cannes Yachting Festival.



BENETEAU

SWIFT TRAWLER

The Swift Trawler 47 is the ideal boat for travelling together with the family, or very comfortably as a couple. She has all the characteristics of a long-distance cruiser and is simple to use. The result of a collaboration between MICAD and Andreani Design, she is the latest addition to a range that has been tirelessly cruising rivers and seas across the world for 15 years.



Both cruising and at anchor, everything is designed to simplify life on board and to enjoy every minute.

JUST LIKE HOME

With three cabins and a sofa bed, the Swift Trawler 47 can provide up to eight very comfortable berths. With an en-suite shower and independent head, the large owner cabin has the makings of a private suite. To port, the guest cabin has twin berths that can be cleverly combined into one, as well as a shower room for guests. A third modular cabin to starboard is perfect for children or can be used as a storage room.





BENETEAU

SWIFT TRAWLER



The atmosphere is convivial in the very spacious high-quality interior of the upper deck. Teak or matt oak, a tasteful blend of fine materials gives it a very contemporary look.

For friends who stop by, the saloon can be turned into an extra cabin by opening out a large and cleverly built-in sofabed. There is absolutely no obstruction when moving around the large lounge with opposite facing seats. With an L-layout and a very large worktop, the galley plays a part in interaction aboard: you can enjoy cooking while talking about some of the more memorable moments with the rest of the crew.





Highly modular, the cockpit can fit a table together with a large bench seat that seamlessly continues the indoor living space. The transom opens onto a large swim platform that can be equipped with a hydraulic lifting system. There is no better way to enjoy the delights of the sea. It is ideal for the tender, bathing and provides stability at anchor.



On the very well-equipped flybridge, you can enjoy the panorama of the sea every minute of the day. Up to three people can sit with the driver. The space is both welcoming and so safe that it makes driving for long distances on the flybridge a real pleasure.



BENETEAU

SWIFT TRAWLER

CRUISING RANGE AND SAFETY

A cruising motorboat must be really energy efficient. The Swift Trawler 47 has already outshone the outstanding performances of earlier models and her fuel consumption is very reasonable. Her fuel tank now has a capacity of 1920 litres and the water tank 680 litres.

The impression of incredible safety inspired by the Swift Trawler 47's robust appearance is confirmed on board by an open deck plan with large walkways, several hand rails and easier access to the boat. The result is that passengers feel as much at ease underway or manoeuvring as they do at anchor.

EASY-GOING AND FUN TO DRIVE

The Swift Trawler 47 has exceptional visibility from the central driver's seat in the wheelhouse, which seats two people very comfortably. The console is designed for two navigation displays together with an aft camera, to make manoeuvring easier. Available from the screens or a connected tablet, Ship Control provides simple centralized access to many of the boat's operations. Already easily



manoeuvrable with its twin motors, the Swift Trawler 47 can also be equipped with a joystick – on the flydeck, in the wheelhouse or in the cockpit – which makes manoeuvring child's play.

The Swift Trawler has inspired many long-distance cruisers since it was launched by Beneteau in 2004. This new addition to the family is not only ingenious, elegant and incredibly safe, but continues the legacy of a range that is cut out for maritime adventure as much as for social life. The temptation to get away from it all and go exploring in style on this uniquely elegant boat, will appeal to the boat lovers and new travellers in search of the ideal boat.

EUROPE CONTACT

Julien Ferre
Mob +33 (0)6 74 22 77 16
j.ferre@beneteau.fr

USA CONTACT

Aurore Bordage
Mob +1 (443) 458 8968
a.bordage@beneteau.com

ASIA PACIFIC CONTACT

Ivy Jin
Mob +852 6877 8297
i.jin@beneteau-group.com

WWW.BENETEAU.COM

PROVISIONAL GENERAL SPECIFICATIONS

Length overall (with aft swim platform + bow anchor)	14,74 m	48'4"
Hull length	12,77 m	41'11"
LWL	4,5 m	14'9"
Hull beam	4,42 m	14'6"
Light displacement (EC) - TBC	19 617 kg	43 236 lbs
Air draught	5,79 m	18'12"
Draught (propeller included)	1,15 m	3'10"
Fuel tank	1 930 L	510 US Gal
Water tank	640 L	169 US Gal
Blackwater tank	175 L	46 US Gal
Optional grey water tank	320 L	320 L
Maximum engine power	2 x 425 CV	2 x 425 HP

ARCHITECTS / DESIGNERS

Naval architect: MICAD
 Design: ANDREANI DESIGN

EC CERTIFICATE (PROVISIONAL)

Category B - 14 persons
 Category C - 16 persons

SWIFT TRAWLER

PLANS



Profile



Profile - FLY

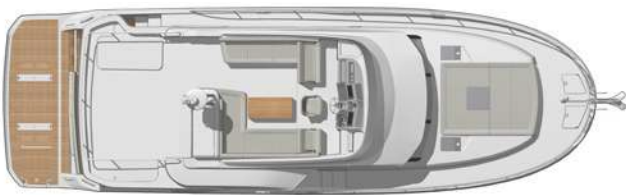

Top view - FLY



Main deck

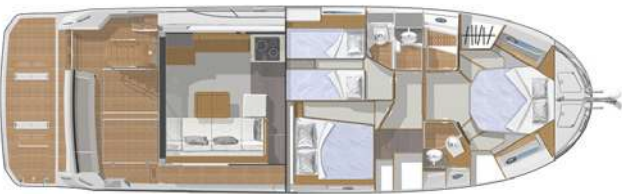

Lower deck / 2 Heads 3 Cabins
